

Lyndon & Fannie Banister

Lyndon V. Banister

Born: 1862 Oregon
Died: July 2, 1950 Klamath Co., OR
Father's Birth Place: Illinois or New York
Mother's Birth Place: Ohio

Fannie J. Banister

Born: 1869 Oregon
Father's Birth Place: Scotland or Ireland
Mother's Birth Place: Oregon

1876 Hugo Homestead On August 15, 1876 Garrett Crockett was issued a homestead patent for 160 acres in Hugo, Oregon (Patent No. 702).¹

1880 Census. Union Town Precinct, Jackson County, Oregon

Robert Bannester	Head	NY	1830	50 yrs
Mary Bannester	Wife	OH	1840	40 yrs
William Bannester	Son	CA	1858	22 yrs
Ellen Morrison	Daughter	CA	1860	20 yrs
<u>Lyndon Bannester</u>	<u>Son</u>	<u>OR</u>	<u>1862</u>	<u>18 yrs</u>
Agness Bannester	Daughter	OR	1864	16 yrs
Alice Bannester	Daughter	OR	1868	12 yrs
Lizzie Bannester	Daughter	OR	1870	10 yrs
Ward Bannester	Son	OR	1877	3 yrs
Elsie Bannester	Daughter	OR	1880	1 m
William Morrison	Grandson	OR	1878	2 yrs

1895 L. Barrister owned the old Crockett homestead on Bannister Creek in 1895.²

The Lyndon Banister Family: Hugo Pioneers: ca., 1895 - 1920?

1900 Census. Merlin Precinct, Josephine Co., OR

Robert Banister	Head	IL	1830	70 yrs
Mary Banister	Wife	OH	1840	60 yrs
Elra Banister	Dau	OR	1880	20 yrs
Lousie Banister	Dau	OR	1885	15 yrs
Elizabeth Scharn	Dau	OR	1897	3 yrs
Lois M Scharn	G-Dau	OR	1894	6 yrs

In 1900 Robert Banister was a farmer.

1900 Census. Mt. Reuben Precinct, Josephine County, Oregon

<u>Lyndon Banister</u>	<u>Boarder</u>	<u>OR</u>	<u>1862</u>	<u>38 yrs</u>
Ward Banister	Boarder	OR	1879	21 yrs

Both Lyndon and Ward Banister are quartz miners. They are the sons of Robert and Mary Banister.

1910 Census. ?? Medium search. 020808
[Ancestry Family Tree, Lyndon, 1-50 family trees](#)

1912 Sixteen freight cars, nearly all loaded with way or through freight are in the ditch one mile south at Three Pines, a broken car wheel having caused the wreck of an extra out of Roseburg running as No. 221." Several railroad officials, . . . "including **J. D. Cook, lumberman; Geo. Dean, blacksmith, and Lyndon Banister, farmer**, constituted a board of inquiry that looked into the causes of the wreck. Their report, filed Wednesday noon, finds that no one was responsible for the wreck, it being one of those things that just happens." Rogue River Courier. January 19, 1912. S.P. Freight Train No. 221 Wrecked.

Banister Creek Named After Family

1920 Census. Merlin Precinct, Josephine Co., OR

<u>Lyndon V. Banister</u>	<u>Head</u>	<u>OR</u>	<u>1862</u>	<u>58 yrs</u>
<u>Fannie J. Banister</u>	<u>Wife</u>	<u>OR</u>	<u>1869</u>	<u>51 yrs</u>
Jessie Howen	Dau	OR	1893	27 yrs
Marion R. Rutherford	Son	OR	1910	9 yrs
Marin Haron	Grandchild	OR	1915	4 yrs

Sometime in the 1920s the Lyndon Banister family leaves Josephine County.

1930 Census. Pelican Bay, Klamath Co., OR

<u>Lyndon Banister</u>	<u>Head</u>	<u>OR</u>	<u>1892</u>	<u>68 yrs</u>
<u>Hannie Banister</u>	<u>Wife</u>	<u>OR</u>	<u>1869</u>	<u>61 yrs</u>
Marian Banister	Son	OR	1911	19 yrs

Both Lyndon and his son are laborers in a box factory.

1950 Lyndon K. Banister passed in Klamath County, Oregon. His wife was Frances.⁴

Bannister Creek is named after the Banister family, presumably because of the Lyndon V. Banister's tenure of the old Garrett Crockett homestead which is at the confluence of that creek (i.e., that will be named Banister Creek) and Jumpoff Joe Creek.

Want more information? Contact an officer of the *Hugo Neighborhood* on how you can become involved in your community history and land use.

1. Hugo Neighborhood. 2007. Crocketts: Hugo Pioneers. Hugo, OR.
2. Koch, Joseph , Draughtsman. 1895 Official Josephine County, Oregon. Map. Scale 1 inch = 1 mile. Meston - Dygert Book M'F'G. Portland, OR.
3. State Water Resources Board. 1970. Rogue Drainage Basin Oregon. Map No. 15.6. Salem, OR; 1998 Merlin 7.5 minute topo map, Oregon.\n4. Oregon Death Index, 1903-98.

Hugo Neighborhood Association & Historical Society's Mission

This information brochure is one of a series of documents published by the Hugo Neighborhood Association & Historical Society (*Hugo Neighborhood*). It is designed to be shared with neighbors for the purpose of helping protect our rural quality of life by promoting an informed citizenry in decision-making. The *Hugo Neighborhood* is an informal nonprofit charitable and educational organization with a land use and history mission of promoting the social welfare of its neighbors.

Land Use & History

The *Hugo Neighborhood's* land use mission is to promote Oregon Statewide Goal 1 — Citizen Involvement, and to preserve, protect, and enhance the livability and economic viability of its farms, forests, and rural neighbors. It will act, if requested, as a technical resource assisting neighbors to represent themselves.

Its history mission is to educate, collect, preserve, interpret, and research its local history and to encourage public interest in the history of the Hugo area.

Volunteer membership dues are \$10.00 annually per family and normally used for paper, ink, envelopes, publications and mailings. Send us your e-mail address if you want to know what we are doing.

Email: hugo@jeffnet.org

Web Page: <http://jeffnet.org/~hugo/>

Edited by Karen Rose, Wayne McKy, & Mike Walker

HNA&HS Officers

Hal Anthony, Outreach Chair
3995 Russell Road
Grants Pass, Oregon 97526

Wayne McKy, Chair
6497 Hugo Road
Grants Pass, Oregon 97526

Mike Walker, Education Chair
3388B Merlin Rd #195
Grants Pass, Oregon 97526

Karen Rose, Web Master
575 Red Mountain Drive
Grants Pass, Oregon 97526



Very Draft
Brochure 19 Of Hugo's Early
Settler Brochure Series

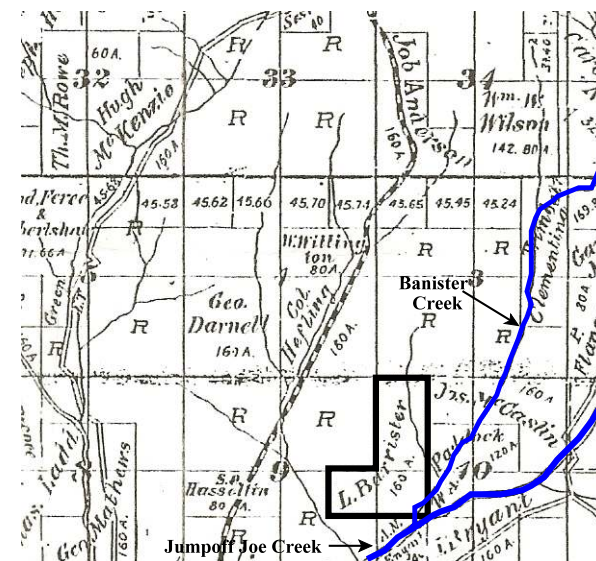

Not Quality Controlled, Nor Edited

L. Banister's Hugo 160 Acre Tract: 1895

February 8, 2008

Hugo Neighborhood Association &
Historical Society

Brochure 19 in Hugo's Early Settler Brochure Series

HNA & HS 2008 - 19

C:\Documents and Settings\mike\My Documents\Genealogy\History_Brochures\People Settlers 1900 - 1930s\BROCHURE_19 Banister Lyndon 020808.wpd