

Hugo's Early Settlers

For purposes of the Hugo's Settler brochure series, an early Hugo settler includes anyone who lived there sometime from 1900 through the 1930s.

Henry W. Kile

Born:
 Birth Place:
 Father's Birth Place:
 Mother's Birth Place:

??

Born:
 Birth Place:
 Father's Birth Place:
 Mother's Birth Place:

Simple ancestry search for Josephine Couty, Oregon 1930. 1/22/08

Henry Kile Family, Early Hugo Settler Family: ca., 1940s - 19??

1937 Henry Kile's Hugo Homestead On September 29, 1937 Henry W. Kile was issued a homestead certificate for 40 acres in Hugo, Oregon (Patent No. 019950).¹⁻²

This was a very late homestead. It was located adjacent to the second oldest cash entries in Hugo, Oregon. Solomon purchased 160 acres under Cash Entry No. 662 in Josephine County, Oregon. It was issued August 15, 1865 to Solomon Abraham (April 24, 1820: Sale-Cash Entry (3 Stat. 566)).¹⁻²

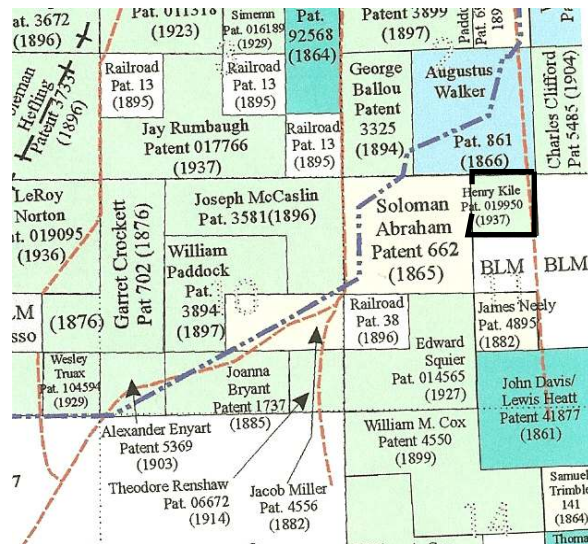

Henry Kile's Homestead: 1937

O & C Homesteader

1920³ The opening of further tracts in the forfeited O. & C. land grant to homestead settlement is attracting the attention of the land hungry of the nation, and thousands will be attracted to Oregon to investigate the lands. Not all who come will settle on these tracts, but many who do not find fortune in that direction will become interested in other lands, and there will be a great stimulation in land movement. These visitors from the east are not going to return from the west once they have seen the advantages offered for home building here.

1930 Homesteads

- 1930 Mary Galbraith
- 1932 John Kidwell
- 1935 Harvey Ritchie
- 1936 LeRoy Norton
- 1937 Jay Rumbaugh
- 1937 Charles Brewer
- 1937 Henry Kile
- 1938 Louis Dillree
- 1939 Pearl Russell
- 1939 Royal Wilson

Want more information? Contact an officer of the *Hugo Neighborhood* on how you can become involved in your community history and land use.

1. Bureau of Land Management (BLM), General Land Office (GLO) Records.
 2007. Official Federal Land Records Site (<http://www.glorerecords.blm.gov/>). Internet.
 2. Hugo Neighborhood. 2007. *Hugo Pioneers*. Map Of Federal Land Transfer in Hugo, Oregon. Hugo, OR.
 3. *Rogue River Courier*. March 19, 1920. Coming For Homesteads; Hugo Neighborhood. 2008. *Hugo Homesteads*. Hugo, Or.

Hugo Neighborhood Association & Historical Society's Mission

This information brochure is one of a series of documents published by the Hugo Neighborhood Association & Historical Society (*Hugo Neighborhood*). It is designed to be shared with neighbors for the purpose of helping protect our rural quality of life by promoting an informed citizenry in decision-making. The *Hugo Neighborhood* is an informal nonprofit charitable and educational organization with a land use and history mission of promoting the social welfare of its neighbors.

Land Use & History

The *Hugo Neighborhood's* land use mission is to promote Oregon Statewide Goal 1 — Citizen Involvement, and to preserve, protect, and enhance the livability and economic viability of its farms, forests, and rural neighbors. It will act, if requested, as a technical resource assisting neighbors to represent themselves.

Its history mission is to educate, collect, preserve, interpret, and research its local history and to encourage public interest in the history of the Hugo area.

Volunteer membership dues are \$10.00 annually per family and normally used for paper, ink, envelopes, publications and mailings. Send us your e-mail address if you want to know what we are doing.

Email: hugo@jeffnet.org
Web Page: <http://jeffnet.org/~hugo/>
Edited by Karen Rose, Wayne McKy, & Mike Walker

HNA&HS Officers

Hal Anthony, Outreach Chair
3995 Russell Road
Grants Pass, Oregon 97526

Wayne McKy, Chair
6497 Hugo Road
Grants Pass, Oregon 97526

Mike Walker, Education Chair
3388B Merlin Rd #195
Grants Pass, Oregon 97526

Karen Rose, Web Master
575 Red Mountain Drive
Grants Pass, Oregon 97526

Not Quality Controlled, Nor Edited

HENRY KILE FAMILY: HUGO SETTLERS



Very Draft
Brochure 230 Of Hugo's Early
Settler Brochure Series



January 22, 2008

**Hugo Neighborhood Association &
Historical Society**