

Edward & ?? Nertney

For purposes of the Hugo's Settler brochure series, an early Hugo settler includes anyone who lived, worked, or owned property there sometime from 1900 through the 1930s.

Edward George Nertney

Born:

Birth Place:

Father's Birth Place:

Mother's Birth Place:

??

Born:

Birth Place:

Father's Birth Place:

Mother's Birth Place:

1. Bureau of Land Management (BLM), General Land Office (GLO) Records. 2007. Official Federal Land Records Site (<http://www.glorerecords.blm.gov/>). Internet.
2. Hugo Neighborhood. 2007. *Hugo Pioneers*. Map Of Federal Land Transfer in Hugo, Oregon. Hugo, OR.
3. *Rogue River Courier*. March 19, 1920. Coming For Homesteads; Hugo Neighborhood. 2008. *Hugo Homesteads*. Hugo, Or.
4. Metsher, Chas. F. 1932 *Metsker Map. Josephine County, Oregon*. Portland, OR.

Simple ancestry search for Josephine County, Oregon
1920 & 1930. 1/31/08

E. G. Nertney
Edward G. Nertney
Edward George Nertney

In 1930 one Edward G. Nertney in San Francisco
Precinct, San Francisco County, California.

The Edward Nertney Family, Hugo Settlers: ca., 1910s - 1930s

1921 Edward Nertney's Hugo Homestead On September 13, 1921 Edward George Nertney was issued a homestead certificate for 120 acres in Hugo, Oregon (Patent No. 012807).¹⁻²

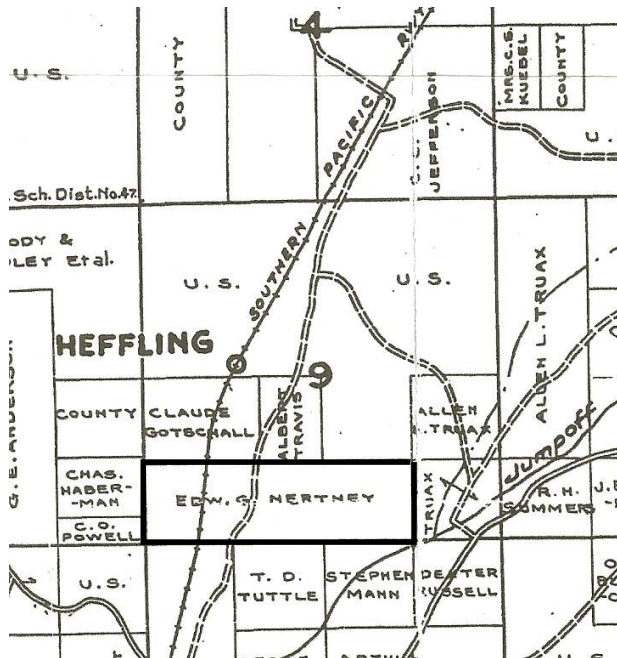

Edward Nertney's Homestead: 1932

Homesteader

1920⁴ The opening of further tracts in the forfeited O. & C. land grant to homestead settlement is attracting the attention of the land hungry of the nation, and thousands will be attracted to Oregon to investigate the lands. Not all who come will settle on these tracts, but many who do not find fortune in that direction will become interested in other lands, and there will be a great stimulation in land movement. These visitors from the east are not going to return from the west once they have seen the advantages offered for home building here.

1920 Homesteads

- 1920 Charles Smith
- 1921 Edward Nertney
- 1923 Charles Andrews
- 1923 George Elsey
- 1923 Silas Ludwick
- 1924 Robert Smith
- 1925 Edgar Fall
- 1926 John Olson
- 1926 Albert Brown
- 1926 George Deane
- 1927 Edward Squier
- 1928 David Leefeld
- 1929 Sylvester Decker
- 1929 John Simemn
- 1929 Wesley Truax

1932 After 11 years Edward Nertney was still in possession of his 120 acre homestead.⁴

Want more information? Contact an officer of the *Hugo Neighborhood* on how you can become involved in your community's history and land use.

Hugo Neighborhood Association & Historical Society's Mission

This information brochure is one of a series of documents published by the Hugo Neighborhood Association & Historical Society (*Hugo Neighborhood*). It is designed to be shared with neighbors for the purpose of helping protect our rural quality of life by promoting an informed citizenry in decision-making. The *Hugo Neighborhood* is an informal nonprofit charitable and educational organization with a land use and history mission of promoting the social welfare of its neighbors.

Land Use & History

The *Hugo Neighborhood's* land use mission is to promote Oregon Statewide Goal 1 — Citizen Involvement, and to preserve, protect, and enhance the livability and economic viability of its farms, forests, and rural neighbors. It will act, if requested, as a technical resource assisting neighbors to represent themselves.

Its history mission is to educate, collect, preserve, interpret, and research its local history and to encourage public interest in the history of the Hugo area.

Volunteer membership dues are \$10.00 annually per family and normally used for paper, ink, envelopes, publications and mailings. Send us your e-mail address if you want to know what we are doing.

Email: hugo@jeffnet.org

Web Page: <http://jeffnet.org/~hugo/>

Edited by Karen Rose, Wayne McKy, & Mike Walker

HNA&HS Officers

Hal Anthony, Outreach Chair
3995 Russell Road
Grants Pass, Oregon 97526

Wayne McKy, Chair
6497 Hugo Road
Grants Pass, Oregon 97526

Mike Walker, Education Chair
3388B Merlin Rd #195
Grants Pass, Oregon 97526

Karen Rose, Web Master
575 Red Mountain Drive
Grants Pass, Oregon 97526

EDWARD NERTNEY FAMILY: HUGO SETTLERS



Very Draft
Brochure 295 Of Hugo's Early
Settler Brochure Series

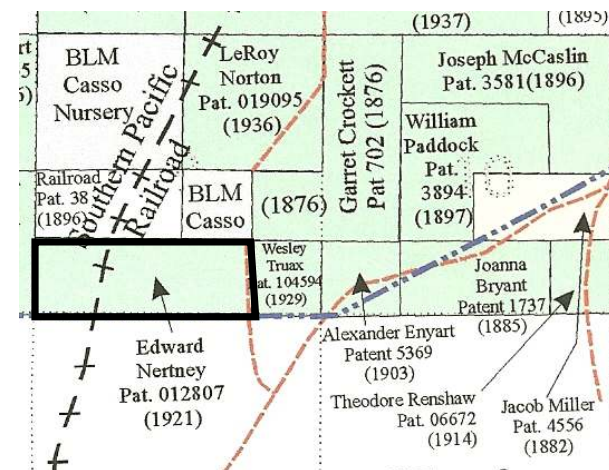

Edward Nertney's Hugo Homestead: 1921

Not Quality Controlled, Nor Edited

January 31, 2008

Hugo Neighborhood Association &
Historical Society