

Joseph & Mattie Hill

Joseph Hill

Born: 1854
Birth Place: Missouri
Father's Birth Place: Cuba
Mother's Birth Place:

Mattie A. Hill

Born: 1864
Birth Place: Illinois
Father's Birth Place: Missouri
Mother's Birth Place: Georgia or Indiana



1895 Joseph Hill was providing up 160 acres in Hugo, Oregon in 1895 under the rules of the homestead law.¹ The ground was in Tunnel Creek southwest of the bend in the tracks of the Southern Pacific Railroad.

The intent of the 1862 Homestead Act was to grant land for agriculture. James, and other claimants, had to prove they lived on the land for a minimum of five years, and made the required improvements before they were eligible to be issued a certificate. For a variety of reasons, the "proving up" period was five to 10 years and longer.

1. Koch, Joseph, Draughtsman. 1895 Official Josephine County, Oregon. Map. Scale 1 inch = 1 mile. Meston - Dygert Book M'F'G, Portland, OR.
2. Bureau of Land Management (BLM), General Land Office (GLO) Records. 2007. Official Federal Land Records Site (<http://www.glorerecords.blm.gov/>). Internet.
3. Hugo Neighborhood. 2007. *Hugo Pioneers*. Map Of Federal Land Transfer in Hugo, Oregon. Hugo, OR.

The Hill Family, Hugo Pioneers: ca., 1890s

1898 Joseph Hill's Hugo Homestead On April 25, 1898 Joseph Hill was issued a homestead patent for 160 acres in Hugo, Oregon (Patent No. 4140).²⁻³

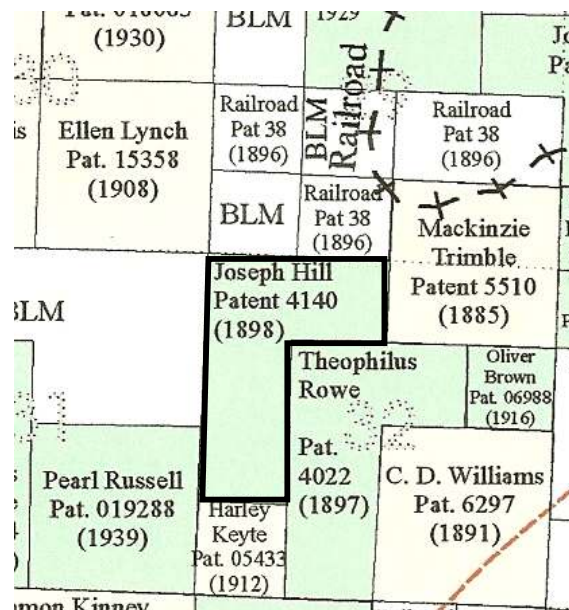

Joseph Hill 160 Acre Hugo Homestead: 1898

Tunnel Creek

History of Property

1895	Joseph Hill	(160 acres)
1898	Joseph Hill	(160 acres)
1932	Beegle	(120 acres)
	R. S. Crockett	(40 acres)

There was a Mr. Hill that taught Margaret Bland Wallen's older brother when she was a kid in the Quartz Creek School - 1910s?.

1910 Census, Grants Pass Precinct, Josephine County, Oregon

Joseph and Mattie had no children. They adopted Son George B., age eight, in 1910.

Hill was a placer miner.

1930 Census, Ferry Precinct, Josephine County, Oregon

Josephine Hill was a farmer.

Want more information? Contact an officer of the *Hugo Neighborhood* on how you can become involved in your community's history and land use.

Hugo Neighborhood Association & Historical Society's Mission

This information brochure is one of a series of documents published by the Hugo Neighborhood Association & Historical Society (*Hugo Neighborhood*). It is designed to be shared with neighbors for the purpose of helping protect our rural quality of life by promoting an informed citizenry in decision-making. The *Hugo Neighborhood* is an informal nonprofit charitable and educational organization with a land use and history mission of promoting the social welfare of its neighbors.

Land Use & History

The *Hugo Neighborhood's* land use mission is to promote Oregon Statewide Goal 1 — Citizen Involvement, and to preserve, protect, and enhance the livability and economic viability of its farms, forests, and rural neighbors. It will act, if requested, as a technical resource assisting neighbors to represent themselves.

Its history mission is to educate, collect, preserve, interpret, and research its local history and to encourage public interest in the history of the Hugo area.

Volunteer membership dues are \$10.00 annually per family and normally used for paper, ink, envelopes, publications and mailings. Send us your e-mail address if you want to know what we are doing.

Email: hugo@jeffnet.org

Web Page: <http://www.hugoneighborhood.org/>

Edited by Jean Boling, Karen Rose,
Wayne McKy, & Mike Walker

HNA&HS Officers

Wayne McKy, Chair
6497 Hugo Road
Grants Pass, Oregon 97526

Mike Walker, Education Chair
3388B Merlin Rd #195
Grants Pass, Oregon 97526

Web Master

Karen Rose, Web Master
575 Red Mountain Drive
Grants Pass, Oregon 97526

Josephine County Historical Society

Jean Boling, Historic Sites Chair
Josephine County Historical Society
124 NW Booth Street
Grants Pass, Oregon 97526

Not Quality Controlled, Nor Edited

HILL FAMILY: HUGO PIONEERS



Draft
Brochure 33 in Hugo's Pioneers
Brochure Series



1940 Aerial Photo

**June 9, 2008
Updated July 3, 2011**

**Hugo Neighborhood Association &
Historical Society**

Josephine County Historical Society