

## Joseph & Helen Rivers: Hugo's Early Settlers

For purposes of the Hugo's Settler brochure series, an early Hugo settler includes anyone who lived there anytime not before 1900 and through 1930.

### Joseph Rivers

Born: 1848  
 Birth Place: Canada  
 Father's Birth Place: Canada  
 Mother's Birth Place: Canada

### Helen Rivers

Born: 1869  
 Birth Place: Rhode Island  
 Father's Birth Place: England  
 Mother's Birth Place: Rhode Island

## Joseph Rivers Family, Hugo Settler Family: 19?? - 1960s

### 1930 Census. Lucky Queen Precinct, Josephine County, Oregon

Joseph Rivers	Head	Canada	1848	82 yrs
Helen Rivers	Wife	Rhode Is.	1869	61 yrs

They owned and farmed their land.

**1932** The Rivers were living on Bummer Creek Lane in Hugo, Oregon.<sup>1</sup> They grew pasture and put up hay as well as raised goats and cattle.<sup>2</sup>

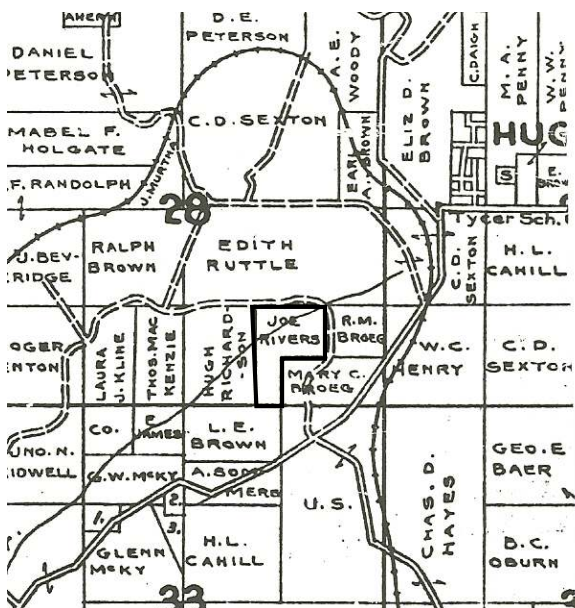

*Rivers' Bummer Creek Lane Ranch: 1932*

## More Information

**1930** Twenty-nine year old Frank Buffington was a farmer. One job he had was taking care the of Joe and Helen River's place after Joe got too old. He would take care of the chores and livestock. Joe die and Frank kept working for Helen.

**1955** A 1955 Metsker map shows Frank owning the Rivers' old property land.<sup>3</sup>

**Want more information?** Contact an officer of the *Hugo Neighborhood* on how you can become involved in your community's history and land use.

1. Metsher, Chas. F. *1932 Metsker Map. Josephine County, Oregon.* Portland, OR.

2. Walker. January 3, 2008. Interview of Wayne McKy of Hugo, Oregon.

3. Metsher, Chas. F. *1955 Metsker Map. Josephine County, Oregon.* Portland, OR.

---

---

## Hugo Neighborhood Association & Historical Society's Mission

This information brochure is one of a series of documents published by the Hugo Neighborhood Association & Historical Society (*Hugo Neighborhood*). It is designed to be shared with neighbors for the purpose of helping protect our rural quality of life by promoting an informed citizenry in decision-making. The *Hugo Neighborhood* is an informal nonprofit charitable and educational organization with a land use and history mission of promoting the social welfare of its neighbors.

### Land Use & History

The *Hugo Neighborhood's* land use mission is to promote Oregon Statewide Goal 1 — Citizen Involvement, and to preserve, protect, and enhance the livability and economic viability of its farms, forests, and rural neighbors. It will act, if requested, as a technical resource assisting neighbors to represent themselves.

Its history mission is to educate, collect, preserve, interpret, and research its local history and to encourage public interest in the history of the Hugo area.

Volunteer membership dues are \$10.00 annually per family and normally used for paper, ink, envelopes, publications and mailings. Send us your e-mail address if you want to know what we are doing.

Email: [hugo@jeffnet.org](mailto:hugo@jeffnet.org)  
Web Page: <http://jeffnet.org/~hugo/>  
Edited by Karen Rose, Wayne McKy, & Mike Walker

---

---

### HNA&HS Officers

Hal Anthony, Outreach Chair  
3995 Russell Road  
Grants Pass, Oregon 97526

Wayne McKy, Chair  
6497 Hugo Road  
Grants Pass, Oregon 97526

Mike Walker, Education Chair  
3388B Merlin Rd #195  
Grants Pass, Oregon 97526

Karen Rose, Web Master  
575 Red Mountain Drive  
Grants Pass, Oregon 97526

**Not Quality Controlled, Nor Edited**

---

---

# JOSEPH RIVERS FAMILY: HUGO SETTLERS



**Very Draft**  
Brochure 343 Of Hugo's Early  
Settler Brochure Series



**January 4, 2008**

**Hugo Neighborhood Association &  
Historical Society**