

## Hugo's Early Settlers

For purposes of the Hugo's Settler brochure series, an early Hugo settler includes anyone who lived there sometime from 1900 through the 1930s.

### Jay Vance Rumbaugh

Born:

Birth Place:

Father's Birth Place:

Mother's Birth Place:

Simple ancestry search for Josephine Couty, Oregon 1930. 1/23/08

## Jay Rumbaugh Family, Early Hugo Settlers: 19?? -

**1937 Jay Rumbaugh's Hugo Homestead** On April 23, 1937 Jay Vance Rumbaugh was issued a homestead certificate for 160 acres in Hugo, Oregon (Patent No. 017766).<sup>1-2</sup>

The location in today terms would be south of the old Ludwick Ranch at the end of Jack Pine Road.

**1955** The Rumbaugh homestead was in the possession of others by 1955.<sup>3</sup>

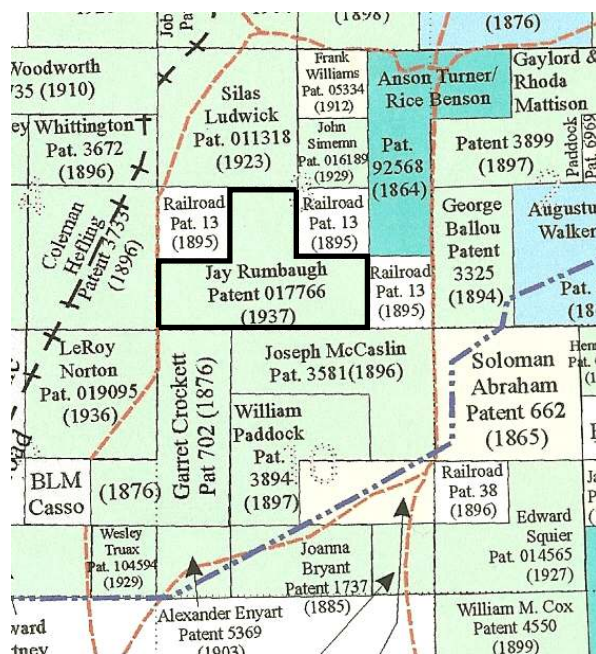

*Jay Rumbaugh's Hugo Homestead: 1937*

## Homesteader

**1920**<sup>4</sup> The opening of further tracts in the forfeited O. & C. land grant to homestead settlement is attracting the attention of the land hungry of the nation, and thousands will be attracted to Oregon to investigate the lands. Not all who come will settle on these tracts, but many who do not find fortune in that direction will become interested in other lands, and there will be a great stimulation in land movement. These visitors from the east are not going to return from the west once they have seen the advantages offered for home building here.

### 1930 Homesteads

- 1930 Mary Galbraith
- 1932 John Kidwell
- 1935 Harvey Ritchie
- 1936 LeRoy Norton
- 1937 Jay Rumbaugh
- 1937 Charles Brewer
- 1937 Henry Kile
- 1938 Louis Dillree
- 1939 Pearl Russell
- 1939 Royal Wilson

**Want more information?** Contact an officer of the *Hugo Neighborhood* on how you can become involved in your community history and land use.

1. Bureau of Land Management (BLM), General Land Office (GLO) Records. 2007. Official Federal Land Records Site (<http://www.glorerecords.blm.gov/>). Internet.

2. Hugo Neighborhood. 2007. *Hugo Pioneers*. Map Of Federal Land Transfer in Hugo, Oregon. Hugo, OR.

3. Metsher, Chas. F. 1955 *Metsker Map. Josephine County, Oregon*. Portland, OR

4. *Rogue River Courier*. March 19, 1920. Coming For Homesteads; Hugo Neighborhood. 2008. *Hugo Homesteads*. Hugo, Or.

---

---

## Hugo Neighborhood Association & Historical Society's Mission

This information brochure is one of a series of documents published by the Hugo Neighborhood Association & Historical Society (*Hugo Neighborhood*). It is designed to be shared with neighbors for the purpose of helping protect our rural quality of life by promoting an informed citizenry in decision-making. The *Hugo Neighborhood* is an informal nonprofit charitable and educational organization with a land use and history mission of promoting the social welfare of its neighbors.

### Land Use & History

The *Hugo Neighborhood's* land use mission is to promote Oregon Statewide Goal 1 — Citizen Involvement, and to preserve, protect, and enhance the livability and economic viability of its farms, forests, and rural neighbors. It will act, if requested, as a technical resource assisting neighbors to represent themselves.

Its history mission is to educate, collect, preserve, interpret, and research its local history and to encourage public interest in the history of the Hugo area.

Volunteer membership dues are \$10.00 annually per family and normally used for paper, ink, envelopes, publications and mailings. Send us your e-mail address if you want to know what we are doing.

Email: [hugo@jeffnet.org](mailto:hugo@jeffnet.org)

Web Page: <http://jeffnet.org/~hugo/>

Edited by Karen Rose, Wayne McKy, & Mike Walker

---

---

### HNA&HS Officers

Hal Anthony, Outreach Chair  
3995 Russell Road  
Grants Pass, Oregon 97526

Wayne McKy, Chair  
6497 Hugo Road  
Grants Pass, Oregon 97526

Mike Walker, Education Chair  
3388B Merlin Rd #195  
Grants Pass, Oregon 97526

Karen Rose, Web Master  
575 Red Mountain Drive  
Grants Pass, Oregon 97526

**Not Quality Controlled, Nor Edited**

---

---

## JAY RUMBAUGH FAMILY: HUGO SETTLERS



**Very Draft**  
Brochure 348 Of Hugo's Early  
Settler Brochure Series



**January 23, 2008**

**Hugo Neighborhood Association &  
Historical Society**

Brochure 348 in Hugo's Early Settler Brochure Series

HNA&HS 2007 - 348

C:\Documents and Settings\mike\My Documents\Genealogy\History\_Brochures\People Settlers 1900 -  
1930s\BROCHURE\_348 Rumbaugh Jay 012308.wpd