

---

---

## George & Emily Tavis: Hugo's Early Settlers

### George W. Tavis

Born: 1867 Illinois  
Father & Mother's Birth Place: Illinois

### Emily Tavis

Born: 1876 Nebraska  
Father & Mother's BP: Iowa Missouri

**1885 Hugo Homestead** Clementina Trimble was issued a homestead patent for 171.66 acres in Hugo, Oregon in 1885 (Patent No. 1781).<sup>1</sup> Wood Feree and Robertshaw owned the old Trimble homestead in 1895.<sup>2</sup>

### 1900 Census. Slate Creek Precinct, Josephine Co., OR

Thomas T. Wise Partner IA 1869 31 yrs

Thomas's occupation was wood chopper.

**1904 - 1908** Thomas and Minta Wise purchased the property in 1904 from James Roberts law. He was particularly known throughout the area as a breeder of thoroughbred Jersey cows. Wise farmed the land until his death in 1908.

---

1. Bureau of Land Management (BLM), General Land Office (GLO) Records. 2007. Official Federal Land Records Site (<http://www.glorerecords.blm.gov/>). Internet.

2. Koch, Joseph , Draughtsman. 1895 Official Josephine County, Oregon. Map. Scale 1 inch = 1 mile. Meston - Dygert Book M'F'G. Portland, OR.

3. Metsher, Chas. F. 1932 *Metsker Map. Josephine County, Oregon*. Portland, OR.

4. Atwood, Kay. 1984. Josephine County Historical Resources Inventory: 1983 - 1984. Volume I. Grants Pass, OR.

5. Hugo Neighborhood. 2001. *Margaret Lanore (Bland) Wallen's Quartz Creek Memories: 1912 - 2001*. Hugo, OR.

6. *Rogue River Courier*. September 10, 1917. Hugo.

7. *Rogue River Courier*. January 23, 1920. Three Pines Weekly.

---

---

## Tavis Settler Family, Early Settlers: 1911 - ca.,1920

### 1910 Census. Spring Valley Precinct, Stevens County, Washington

George W. Tarvis	Head	IL	1867	43 yrs
Emily Tarvis	Wife	NE	1876	34 yrs
Elsie M. Tarvis	Dau	WA	1892	18 yrs
Minty M. Tarvis	Dau	WA	1896	14 yrs
Charles J. Tarvis	Son	WA	1898	12 yrs
George WJR Tarvis	Son	WA	1901	9 yrs
Willaim I. Tarvis	Son	WA	1902	8 yrs
John E. Tarvis	Son	WA	1906	4 yrs
Thomas L. Wise	Hired Man	NE	1867	43 yrs
Isaac Tavis	Father	IL	1838	72 yrs
Maersa Tavis	Mother	IL	1839	71 yrs

In the 1910 census George was identified as a farmer; Thomas was a hired man. The ultimate 300 acre Wise-Tavis ranch was comprised of the old Trimble homestead and, land from the railroad, and more parcels.<sup>3</sup>

**1911** The members of the Wise family granted their parts of the farm estate to their brother-in-law, George W. Tavis, a resident of Washington state. George immediately moved to the farm and took over the stock operation.<sup>4</sup>

**ca., 1917 - 1920** Mr. Hill was a teacher at the Quartz Creek School. He taught Margaret's older brothers. One time adults George Tavis and Buck Buffington came on horse back and rode around the Quartz Creek School when Dick Bland was attending the school. The two men were dressed as Indians and were whooping and yelling and scared the school kids half-to-death.<sup>5</sup>

---

---

## Wise-Tavis Pole Barn

**1917** George Tavis returned home from Harrisburg where he spent the summer.<sup>6</sup>

**1920** George Tavis and Alex Tavis, of Hugo, visited at the Ludwick home Monday evening.<sup>7</sup>

**1920** The Tavis family farmed there until George was killed when struck by a Southern Pacific train on July 16, 1920.<sup>4&8</sup>

### 1920 Census. Lucky Queen Precinct, Josephine County, Oregon

William I. Tavis	Head	WA	1902	16 yrs
Emily Tavis	Mother	NE	1876	42 yrs
John E. Tavis	Brother	WA	1906	14 yrs

### 1930 Census. Merlin Precinct, Josephine Co., OR

Thomas **L. Wise** **Head** **IA** 1868 62 yrs

**1932** Thos. L. Wise was in possession of the farm.<sup>2</sup>

**Importance**<sup>4</sup> The Tavis and Wise families were well known through the Merlin-Hugo area and relatives continue to reside there. The barn is one of the oldest barns in the Merlin-Hugo region and the complete pole construction is unique.

**Want more information?** Contact an officer of the *Hugo Neighborhood* on how you can become involved in your community's history and land use.

---

8. *Rogue River Courier*. 1920. Man Ground to Death Under Train Wheels.

## Hugo Neighborhood Association & Historical Society's Mission

This information brochure is one of a series of documents published by the Hugo Neighborhood Association & Historical Society (*Hugo Neighborhood*). It is designed to be shared with neighbors for the purpose of helping protect our rural quality of life by promoting an informed citizenry in decision-making. The *Hugo Neighborhood* is an informal nonprofit charitable and educational organization with a land use and history mission of promoting the social welfare of its neighbors.

### Land Use & History

The *Hugo Neighborhood's* land use mission is to promote Oregon Statewide Goal 1 — Citizen Involvement, and to preserve, protect, and enhance the livability and economic viability of its farms, forests, and rural neighbors. It will act, if requested, as a technical resource assisting neighbors to represent themselves.

Its history mission is to educate, collect, preserve, interpret, and research its local history and to encourage public interest in the history of the Hugo area.

Volunteer membership dues are \$10.00 annually per family and normally used for paper, ink, envelopes, publications and mailings. Send us your e-mail address if you want to know what we are doing.

Email: [hugo@jeffnet.org](mailto:hugo@jeffnet.org)

Web Page: <http://jeffnet.org/~hugo/>

Edited by Karen Rose, Wayne McKy, & Mike Walker

### HNA&HS Officers

Hal Anthony, Outreach Chair  
3995 Russell Road  
Grants Pass, Oregon 97526

Wayne McKy, Chair  
6497 Hugo Road  
Grants Pass, Oregon 97526

Mike Walker, Education Chair  
3388B Merlin Rd #195  
Grants Pass, Oregon 97526

Karen Rose, Web Master  
575 Red Mountain Drive  
Grants Pass, Oregon 97526

# GEORGE W. TAVIS FAMILY: HUGO SETTLERS



Very Draft  
Brochure 390 Of Hugo's Early  
Settler Brochure Series

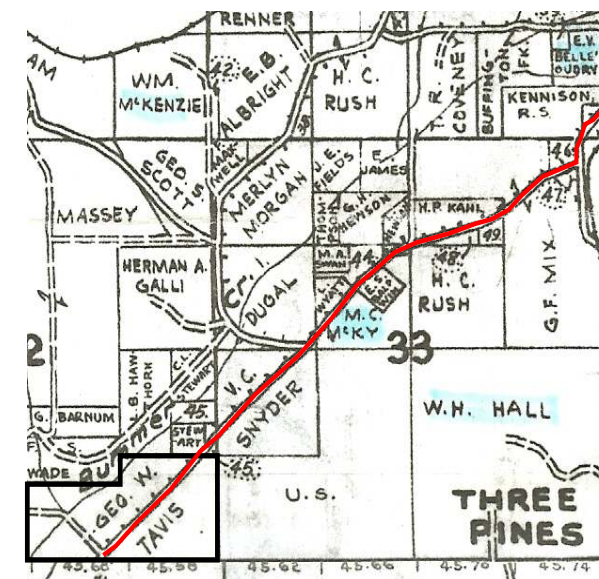

George Tavis' Hugo Ranch: 1955

Not Quality Controlled, Nor Edited

April 22, 2008

Hugo Neighborhood Association &  
Historical Society

Brochure 390 in Hugo's Early Settler Brochure Series  
HNA&HS 2007 - 390

C:\Documents and Settings\mike\My Documents\Genealogy\History\_Brochures\People Settlers 1900 -  
1930s\BROCHURE\_390 Tavis George 001608.wpd