

Thomas H. Powers

Thomas H. Powers

Born: 1838
 Birth Place: Missouri
 Father's Birth Place: New York
 Mother's Birth Place: Pennsylvania

1894 Thomas Powers' Hugo Homestead

On May 16, 1894 Thomas H. Powers was issued a homestead certificate for 80 acres in Hugo, Oregon (Patent No. 3239).¹⁻² The intent of the 1862



Homestead Act was to grant land for agriculture. Thomas, and other claimants, had to prove they lived on the land for a minimum of five years, and made the required improvements before they were eligible to be issued a certificate. For a variety of reasons, the "proving up" period was five to 10 years and longer.

Thomas H. Powers, Hugo Pioneer: 1880s - 19??

1895 Thomas Powers was in possession of his homestead in Hugo, Oregon.³ The homestead was up the Quartz Creek drainage.

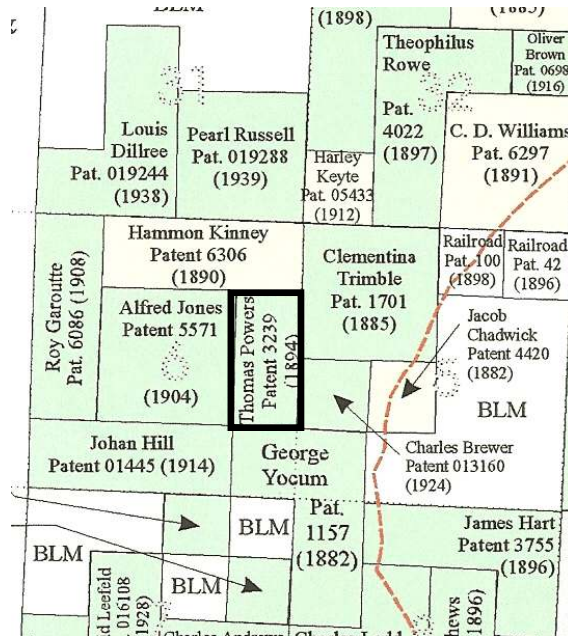

Thomas H. Powers' Homestead: 1894

1900 Census. Merlin Precinct, Josephine Co., OR

Thomas H. Powers Head MO 1838 62 yrs

In 1900 Thomas Power's occupation was farmer.

Quartz Creek Homesteader

1932 By 1932 the Kuhnhardts had possession of the old Powers' homestead and an additional adjacent 40 acres to the north.

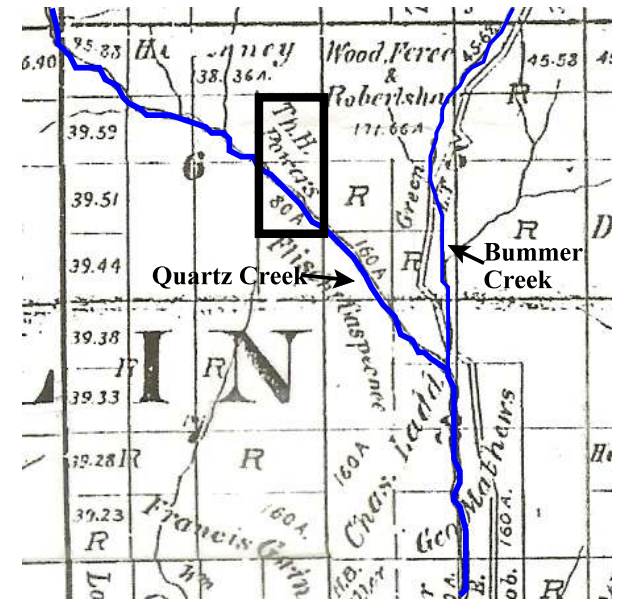

Thomas H. Powers' Quartz Creek Homestead: 1895

Want more information? Contact an officer of the *Hugo Neighborhood* on how you can become involved in your community's history and land use.

1. Bureau of Land Management (BLM), General Land Office (GLO) Records. 2007. Official Federal Land Records Site (<http://www.glorerecords.blm.gov/>). Internet.
 2. Hugo Neighborhood. 2007. *Hugo Pioneers*. Map Of Federal Land Transfer in Hugo, Oregon. Hugo, OR.
 3. Koch, Joseph, Draughtsman. 1895 Official Josephine County, Oregon. Map. Scale 1 inch = 1 mile. Meston - Dygert Book M'F'G. Portland, OR.
 4. Metsher, Chas. F. 1932 *Metsker Map. Josephine County, Oregon*. Portland, OR.

Hugo Neighborhood Association & Historical Society's Mission

This information brochure is one of a series of documents published by the Hugo Neighborhood Association & Historical Society (*Hugo Neighborhood*). It is designed to be shared with neighbors for the purpose of helping protect our rural quality of life by promoting an informed citizenry in decision-making. The *Hugo Neighborhood* is an informal nonprofit charitable and educational organization with a land use and history mission of promoting the social welfare of its neighbors.

Land Use & History

The *Hugo Neighborhood's* land use mission is to promote Oregon Statewide Goal 1 — Citizen Involvement, and to preserve, protect, and enhance the livability and economic viability of its farms, forests, and rural neighbors. It will act, if requested, as a technical resource assisting neighbors to represent themselves.

Its history mission is to educate, collect, preserve, interpret, and research its local history and to encourage public interest in the history of the Hugo area.

Volunteer membership dues are \$10.00 annually per family and normally used for paper, ink, envelopes, publications and mailings. Send us your e-mail address if you want to know what we are doing.

Email: hugo@jeffnet.org

Web Page: <http://www.hugoneighborhood.org/>

Edited by Jean Boling, Karen Rose,
Wayne McKy, & Mike Walker

HNA&HS Officers

Wayne McKy, Chair
6497 Hugo Road
Grants Pass, Oregon 97526

Mike Walker, Education Chair
3388B Merlin Rd #195
Grants Pass, Oregon 97526

Web Master

Karen Rose, Web Master
575 Red Mountain Drive
Grants Pass, Oregon 97526

Josephine County Historical Society

Jean Boling, Historic Sites Chair
214 NW Booth Street
Grants Pass, Oregon 97526

Not Quality Controlled, Nor Edited

Brochure 58 in Hugo's Pioneers Brochure Series

HNA&HS 2008/2011 - 58

C:\Documents and Settings\mike\My Documents\Genealogy\History_Brochures\People Pioneers
1800s\BROCHURE_58 Powers Thomas 011308.wpd

THOMAS POWERS: HUGO PIONEER

Very Draft

Brochure 58 in Hugo's Pioneers Brochure Series

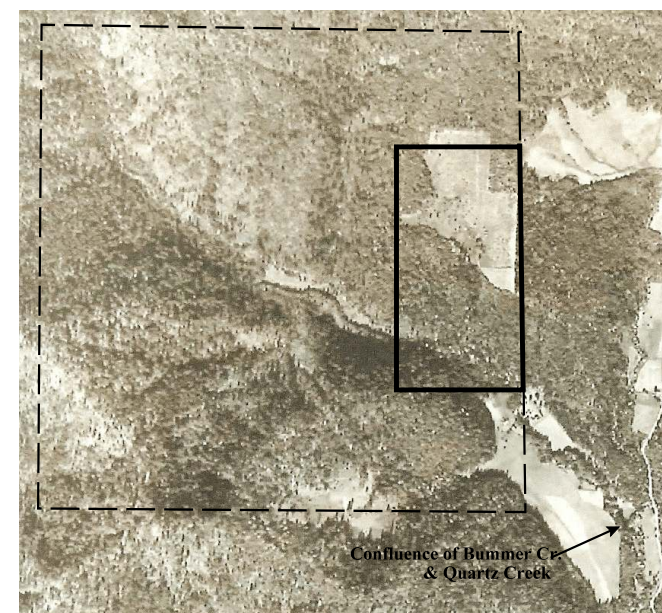

*Thomas Powers' 1894 Quartz Creek Homestead
On 1939 Aerial Photograph*

**January 13, 2008
Updated July 5, 2011**

**Hugo Neighborhood Association &
Historical Society
Josephine County Historical Society**