

Winona Post Office

Winona Post Office: 1897 - 1905 The following information is from the April 7, 1897 application from Herbert M. Gorham for a new post office to the U. S. Post Office Department. The proposed name of the post office was "Gorham".

- It will be situated in the SE quarter of Section 31, Township 34 South, Range 5 West, Willamette Meridian.

- It is not on any existing route and a "Special Office" is wanted to be supplied from the Merlin Post Office.

- The population to be supplied by the proposed office is 65.

On September 20, 1902 the location of the Winona Post Office had been moved to the NW quarter of Section 4, Township 34 South, Range 5 West.

- The post office was on Mail Route No. 73367. The Hugo Post Office was the nearest office.

On October 5, 1903 the location of the Winona Post Office had been moved to the SE quarter of Section 32, Township 34 South, Range 5 West. Mail Route No. 73367.

On October 11, 1904 the location was moved back to Section 31, but now in the NW quarter. Mail Route No. 73367.



Winona Postmasters

Winona (Gorham - Winona): 1897 - 1905 It had a history of lumbering, mining, and farming and was named after the Winona ranch.

Postmasters

Herbert M. Gorham	June 4, 1897 - 1902
Edmund R. Cochrane	August 13, 1902 - 1905

Winona Post Office Locations

1. 1897	SE ¼	Section 31	T.34 S.	R.5W.
2. 1902	NW ¼	Section 4	T.34 S.	R.5W.
3. 1903	SE ¼	Section 32	T.34 S.	R.5W.
4. 1904	NW ¼	Section 31	T.34 S.	R.5W.

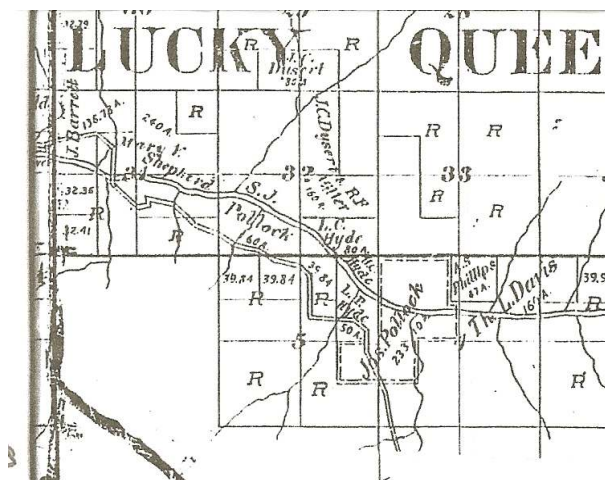

Property Owners For Sections 4, 31, & 32: 1895

More Information

Herbert M. Gorham made the 1897 map showing the location of the proposed Gorham Post Office with the Grave Creek Hills to the north between Gorham and Placer, and Red Mt. and Walker Mt. to the south.

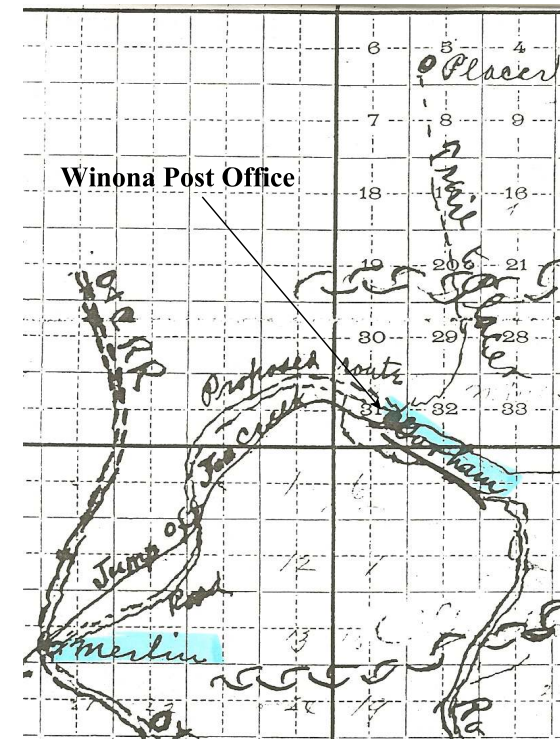

1897 Proposed Gorham Post Office - Sec. 31
National Archives & Records Administration

More Information. Contact an officer of the *Hugo Neighborhood* if you are interested in becoming involved in the history of our area.

Hugo Neighborhood Association & Historical Society's Mission

This information brochure is one of a series of documents published by the Hugo Neighborhood Association & Historical Society (*Hugo Neighborhood*). It is designed to be shared with neighbors for the purpose of helping protect our rural quality of life by promoting an informed citizenry in decision-making. The *Hugo Neighborhood* is an informal nonprofit charitable and educational organization with a land use and history mission promoting the social welfare of its neighbors.

Land Use & History

The *Hugo Neighborhood's* land use mission is to promote the social welfare of the citizens of the area by working to promote Oregon Statewide Goal 1 — Citizen Involvement, and by preserving, protecting, and enhancing the livability and economic viability of its farms, forests, and rural neighbors.

Its history mission is to educate, collect, preserve, interpret, and research its local history and to encourage public interest in the history of the Hugo area.

Voluntary membership dues are \$10.00 annually and will be used for paper, ink, envelopes, publications and mailings. Make checks to the *Hugo Neighborhood* and send them our Treasurer. Send us your e-mail address if you want to know what we are doing.

Hugo Neighborhood Association

Email: hugo@jeffnet.org

Web Page: <http://www.hugoneighborhood.org/>

Edited by Karen Rose, Wayne McKy, & Mike Walker

HNA&HS Officers

Wayne McKy, Chair
6497 Hugo Road
Grants Pass, Oregon 97526

Mike Walker, Education Chair
3388B Merlin Rd #195
Grants Pass, Oregon 97526

Web Master

Karen Rose, Web Master
575 Red Mountain Drive
Grants Pass, Oregon 97526

Winona Post Office: 1897 - 1905



Winona School,
Josephine County, Oregon

Hugo Neighborhood Association & Historical Society
Courtesy of Josephine County Historical Society

Winona School

**October 25, 2007
Updated July 5, 2011**

**Hugo Neighborhood Association &
Historical Society**